

SH Vega

Our elegant 5-star ships offer a boutique home-from-home. With a chic Scandinavian-inspired design and world-class technology, you'll experience an expedition cruise like no other.



Stateroom Category:

- Oceanview D4: 4 (20m²) ●
- Oceanview M4: 12 (20m²) ●
- Balcony D5: 8 (25m²) ●
- Balcony M5: 22 (25m²) ●
- Balcony D6: 24 (25m²) ●
- Suite: 4 (40m²) ●
- Premium Suite: 2 (47m²) ●

Ship Specification:

- Guest Capacity 152
- Staff 117
- No. of Decks 9
- Staterooms 76
- Length 372ft (113.5m)
- Breadth 79.7ft (24.3m)
- Gross Tonnage 10,617
- Service Speed 12 knots
- 3rd Guest Capacity ▲
- 4th Guest Capacity ■
- Connecting Staterooms ↔
- Wheelchair Accessible Staterooms ♿ 415
- Propulsion Hybrid Diesel
Electric, Polar
Class PC5
- Registered Panama
- Lifeboats 2 (fully closed)
- Zodiacs 10 MK5
2 MK6

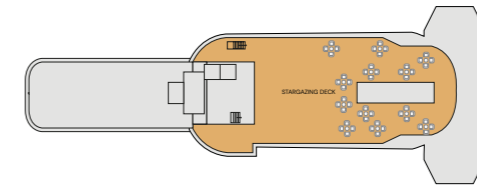

Deck 9
Stargazing Deck



Deck 8
Gym
Sauna
Jacuzzi
Spa
Bridge

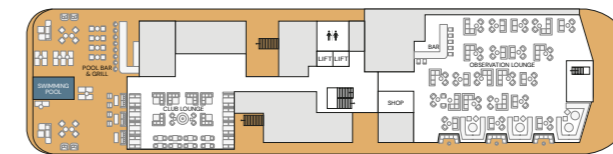

Deck 7
Shop
Swimming Pool
Pool Bar & Grill
Club Lounge
Observation Lounge



Deck 6
Premium Suites
Suites
Balcony Staterooms D6
Swan's Nest



Deck 5
Balcony Staterooms D5, M5
Suites



Deck 4
Reception
Laundrette
Swan Restaurant
Oceanview Staterooms D4, M4

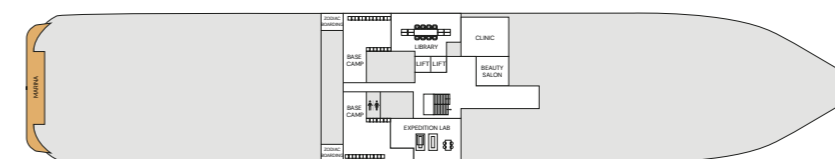

Deck 3
Clinic
Library
Basecamp
Beauty Salon
Expedition Lab